

MEDICAL DIAGNOSIS IMAGING EQUIPMENT

Unlocking the Power of Medical Diagnostic Imaging Equipment



Designed to Meet low leakage ratings and compliance with BF and CF, 2 x MOPP requirements

UNINTERRUPTIBLE POWER SUPPLY (UPS)

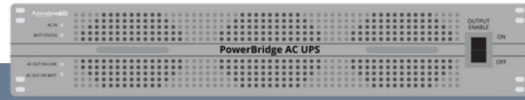

PowerBridge

The **PowerBridge™**, an AC/AC medical UPS system developed by Astrodyne TDI, offers a reliable power backup and patient isolation solution in critical applications. In a power outage, the PowerBridge™ provides an impressive 2kVA of emergency power for over 2 minutes, allowing users to seamlessly bridge the power gap while the system's power gradually ramps up.

AC-DC POWER SUPPLY & POWER LINE FILTER

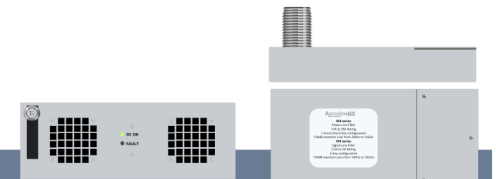

HermesFlex

059 Series

The **HermesFlex™** is a highly adjustable power supply that meets certification standards for patient protection and compliance with BF Leakage Current requirements. With its wide-range DC Output (0-500VDC) and innovative design allowing for parallel current-sharing, the HermesFlex™ offers exceptional flexibility and precision, making it the ideal choice for medical diagnostic equipment. Improve your operations and reliability with the HermesFlex™.

The **059 series** power line filters offer a versatile range of options, with ratings from 10A to 50A. They are designed for AC and low-voltage DC applications, meeting the stringent attenuation requirements of an MRI room with a remarkable 100dB insertion loss from 5MHz to 10GHz.

POWER CONDITIONING & DISTRIBUTION

Astrodyne TDI offers **customized Power Distribution Units (PDU)** tailored to the unique power requirements of medical diagnostic equipment. These high-power PDUs meet specific needs while saving space, time, and cost. With advanced tools and technologies, Astrodyne TDI designs, manufactures, and services PDUs to your unique specifications to overcome your challenges.

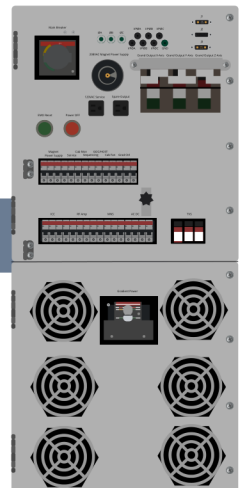

Power Conditioning & Distribution

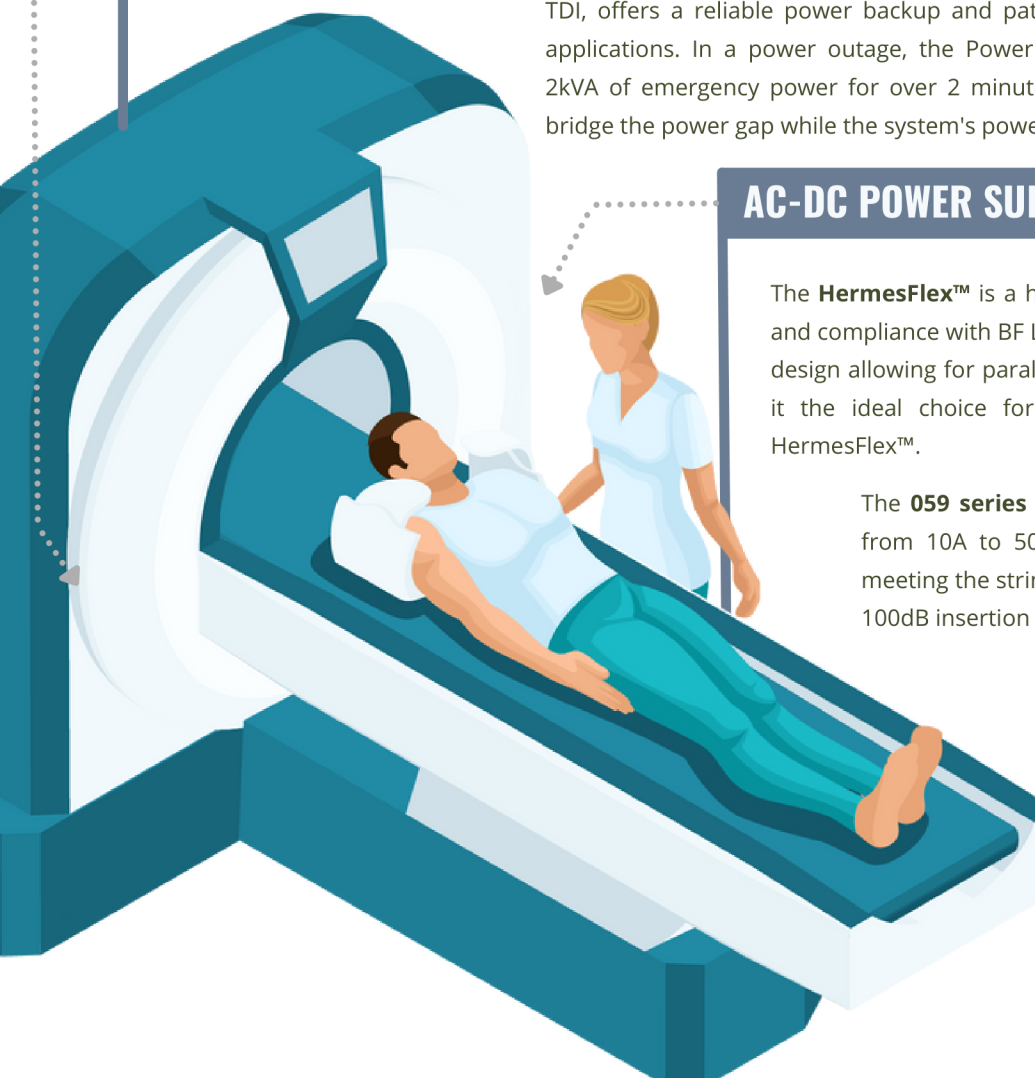



POWER SOLUTION FOR MEDICAL DIAGNOSTIC EQUIPMENT

Benefits of Uninterruptible Power and Power Distribution

Medical/Diagnostic Imaging procedures have revolutionized how healthcare providers approach diagnosis and treatment. They offer a safe and efficient alternative to invasive surgeries, allowing doctors to gain valuable insights into a patient's condition without the need for exploratory procedures. From identifying fractures and tumors to detecting cardiovascular abnormalities and monitoring the development of an unborn child, medical imaging has become an indispensable tool in modern medicine. Astrodyne TDI offers a wide range of capabilities to meet the power requirements of Medical Diagnostic Equipment. Their integrated system PDUs provide power, EMI filters, battery management, and controls in a single solution. With a proven track record of successful programs in the medical field, Astrodyne TDI specializes in tailored solutions and custom capabilities.

Astrodyne TDI offers a wide range of capabilities to meet the unique power requirements of Medical Diagnostic Equipment, including:

- ✓ Integrated system PDUs that encompass power, filters, battery management, and controls in a single solution
- ✓ Quick-turn design utilizing standard power & EMI Filters and manufacturing services to minimize cost and lead time
- ✓ Domestic engineering and local technical support
- ✓ High-quality and low-cost manufacturing
- ✓ Meeting the requirements for BF and CF, with a double level of Means of
- ✓ Patient Protection (MOPP)
- ✓ Self-certified lab and streamlined safety agency certifications



Download our product brochure for more information

